

ASS 70 FD folding/sliding door installation guide



Preparation

IMPORTANT

These doors should be fitted by competent and trained installers. Please read these instructions thoroughly before beginning the installation. Follow the instructions and recommendations given otherwise the system may not function properly and any warranty, written or implied, may be void.

As regulations governing the use of glazed windows, doors, shop fronts and/or partitions vary widely, it is the responsibility of the building owner, architect, contractor or installer to ensure the selected products conform with all applicable codes and regulations.

Tools

In addition to normal installation tools, the following will be required:

1. 3.2 mm long reach drill bits for the adjuster fixing screws.
2. T15 and T20 torx bit screwdrivers for the adjuster and hinge screws.
3. Schueco two-part adhesive and applicator for outer frame corner joints if joined on-site.
4. Nail drift for corner cleats.



Checking the opening

The frame must be fitted plumb and level within the opening. Sizes given for manufacture of the frame should be the tightest point of the opening minus 10 mm fitting tolerance.

The structural integrity of the lintel is critical for the proper functioning of the unit. The deflection of the header under full load should be limited to 3-4 mm maximum.

The opening should be level, plumb and square at all points. There should be no unevenness or bowing.

Ensure the lintel is not twisted and that the floor is even. The sides should be the same and not offset from each other.

A laser or other similar precise measuring equipment should be used to check these requirements and find the fitting points.

If a flush threshold is to be used it should be fitted on to a sub sill to facilitate correct drainage and levelling (see page 5).

To avoid later problems do not install the unit until the opening has been fully and correctly prepared.

Please also refer to your order confirmation for opening direction/door leaf information.

Preparation for outer frame assembly

Lay out the four outer frame profiles flat on the floor to assemble them, making sure the area is clear of debris to prevent damage to the profiles/powder coating. Take into account the opening direction and whether the doors open inwards or outwards. Check that the drain holes are to the outside.

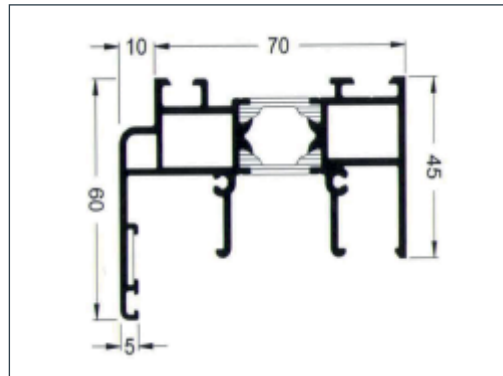

Head profile x 1. Pre-cut as per order

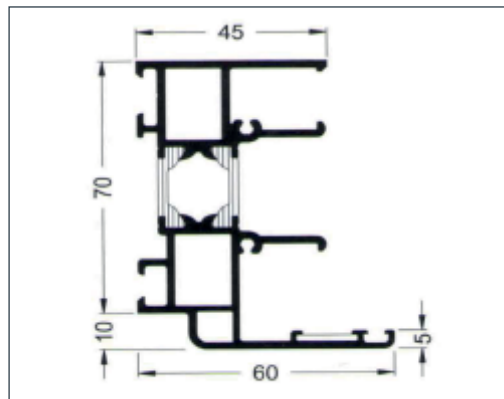

Jamb profile x 2. Pre-cut as per order

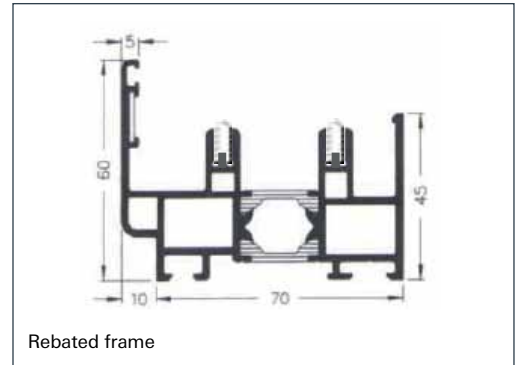

Rebated frame

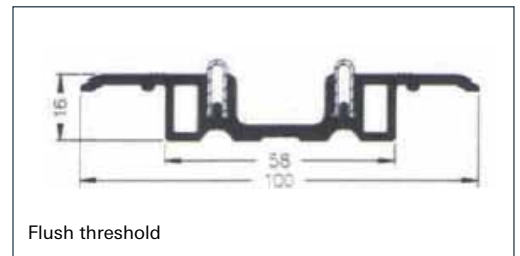

Flush threshold

Bottom profile with track x 1.
Pre-cut as per order, either rebated frame or flush threshold.

Assembling the outer frame

1. The corner cleats must be inserted in the correct position so the holes in the frame line up for the nails. The cleats have a triangle stamped on one side which should face towards the thermal break.
Note: there is also a chevron to be fitted in the profile upstand.
2. Put sealant across the face of the profile mitres.

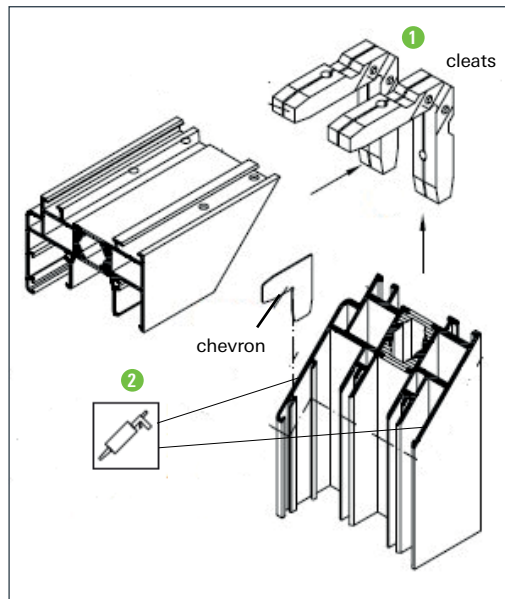

3. Ensure the profiles are correctly aligned and not offset before inserting the nails with a hammer and drift.

WARNING
Once inserted the pins cannot be removed.

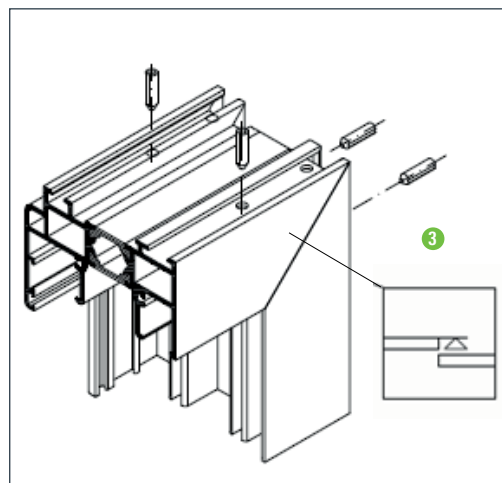

Ensure surfaces are correctly aligned

4. The final strength of the joint is ensured by the application of the Schueco two-part adhesive which is injected into the two remaining holes. The glue is pumped in until it appears in the nail hole positions.
5. Clean off mitres. Seal over nail holes.

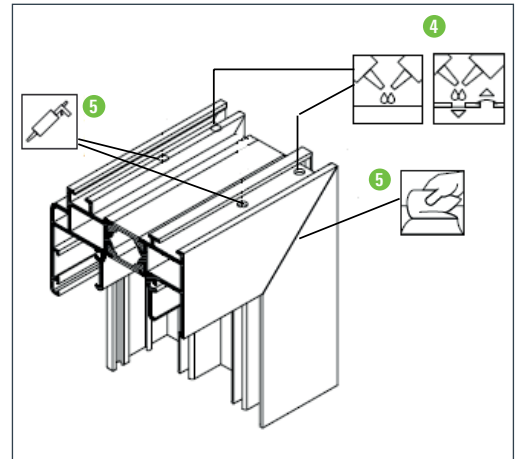

Two-part adhesive and applicator for mitre joints

Frame with flush threshold

1. Seal ends of flush threshold

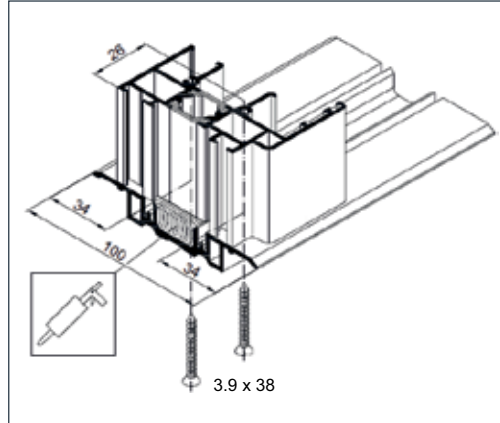

In preparing the opening for a flush threshold it is recommended that a box section of aluminium or galvanised steel is fixed into the structure to provide a level and flat fixing ground. It is important to ensure that the threshold is carefully lined through and not bowed laterally or vertically.

For external applications, careful consideration must be given to the design of the opening to provide measures to minimise the possible ingress of water. Internal carpeted floor coverings should not be used.

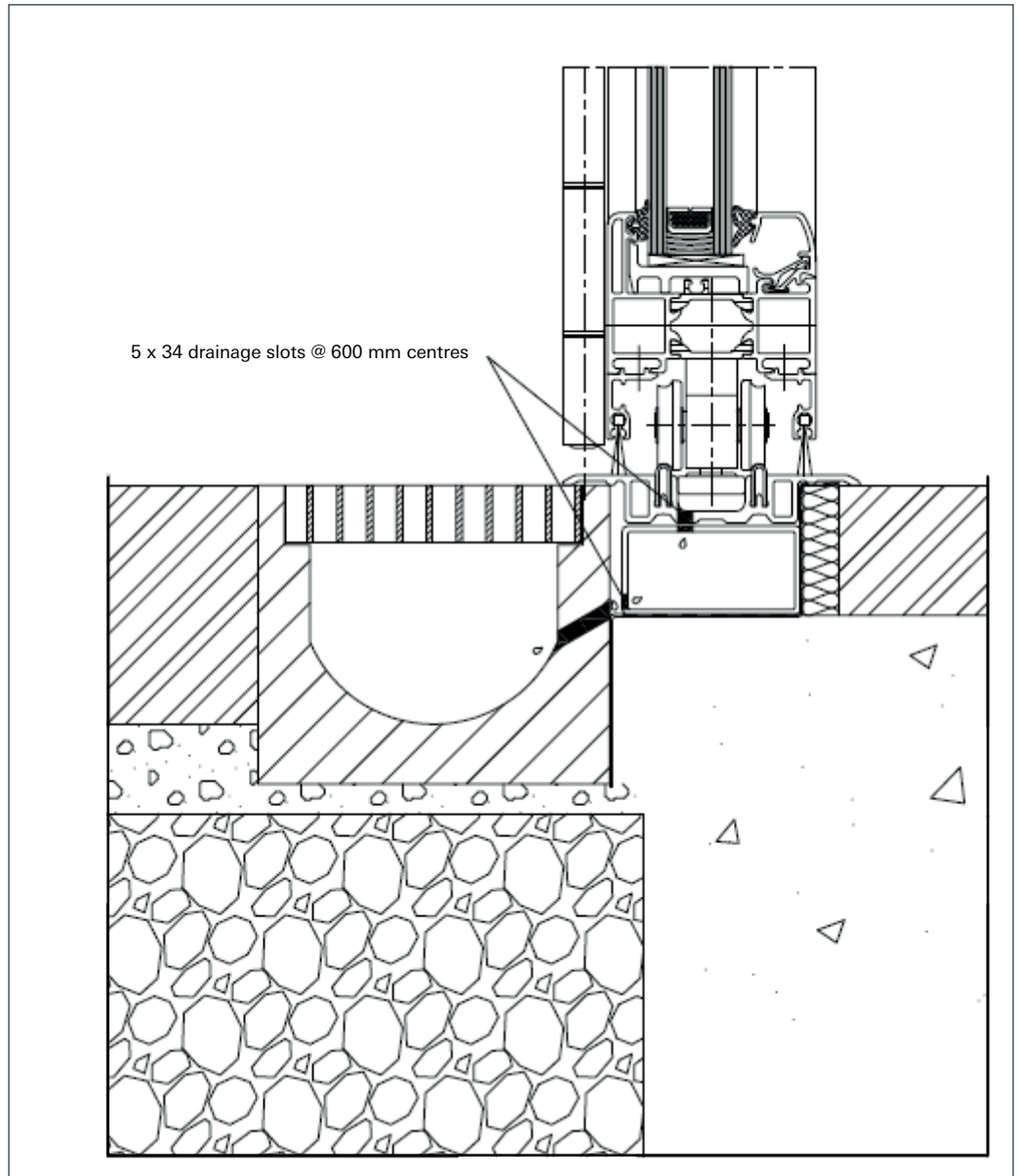

Installation of outer frame into opening

1. Place the frame in the opening and adjust until the frame is square, plumb and level. The top and bottom tracks must be parallel and the jambs must not be offset from each other. **It is very important to fit the outer frame correctly otherwise problems will be encountered when fitting the door leaves.**

Make sure that the opening direction has been taken into account and that the water drain holes face to the outside.

2. Use suitable screws and plugs (to suit sub-structure) and fix the frame to the opening. **Fix through the aluminium and not the thermal break.**

The first fixing should be 150 mm from the corner utilising packers if required to make sure frame is level and plumb in the opening. Then fix at 300-400 mm centres until frame is fully fixed all-round. Pack fixings as necessary.

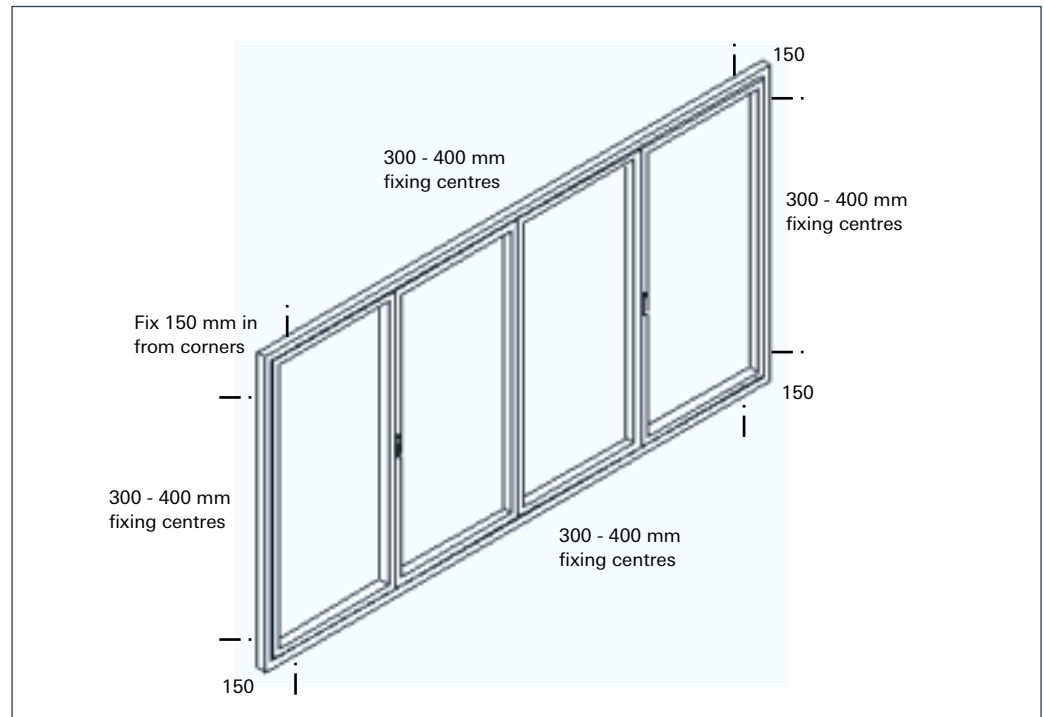
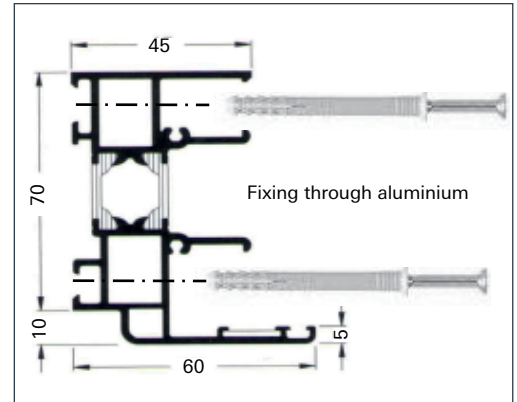

3. Check again that the frame is level and plumb. A laser or other similar precise measuring equipment should be used to check these requirements.

Installation of adjuster profile

The Schueco ASS 70 FD door benefits from a unique frame width adjustment aid. Once the frame is fitted plumb and level, the hinge side frame adjuster can be fitted using the Torx screws supplied in the pack. The frame adjuster allows a lateral adjustment range for the frame from 0 - 8 mm.

The adjusters should be wound out to allow the frame adjuster to be positioned with a 5 mm gap all the way down between the frame and the adjuster. Then tighten the fixings screws.

If the last leaf is floating and shuts onto the adjuster, then this side can be fitted after the doors have been hung. Once all doors have been hung, the adjuster can then be fitted and adjusted as necessary.

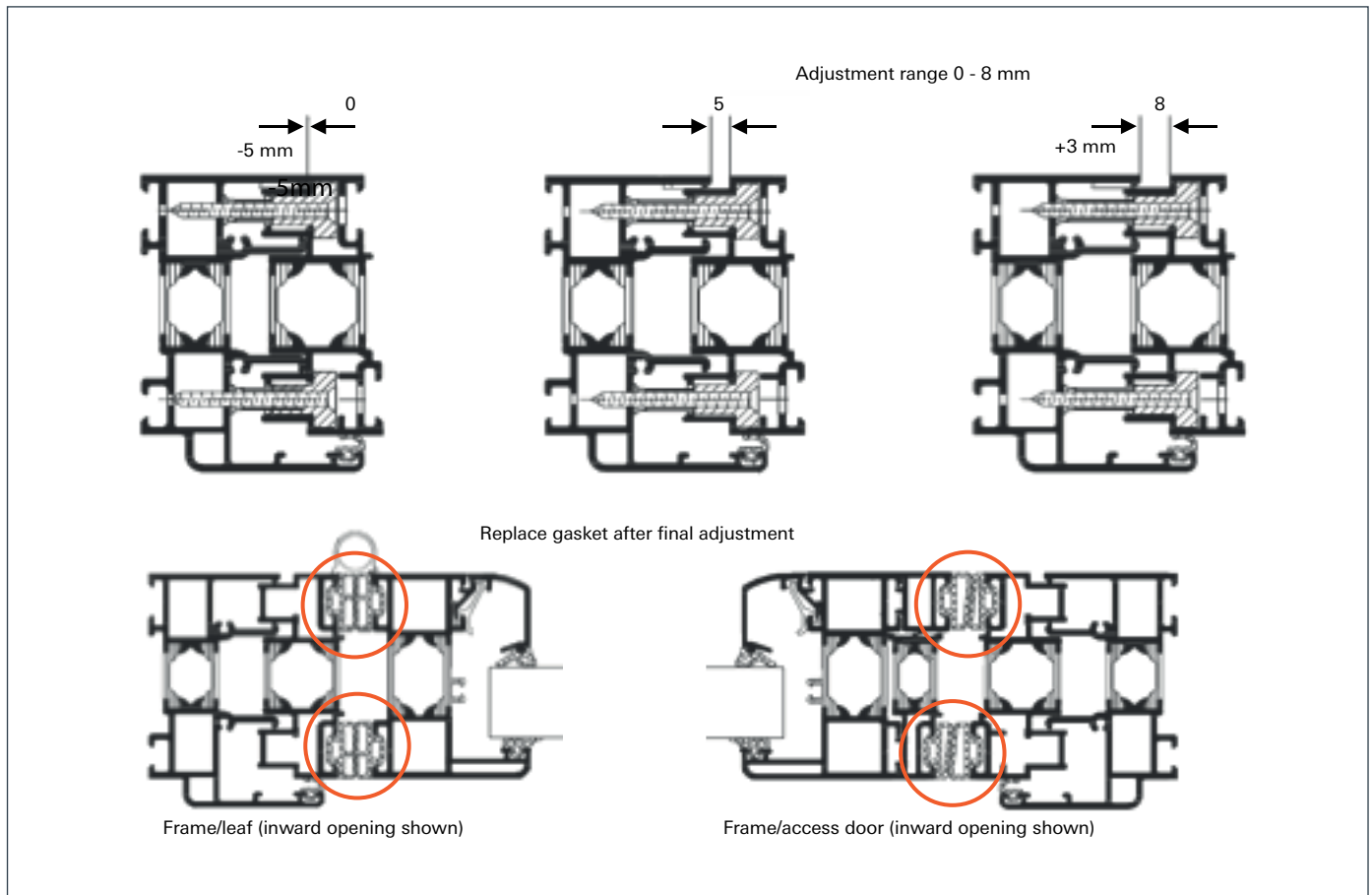
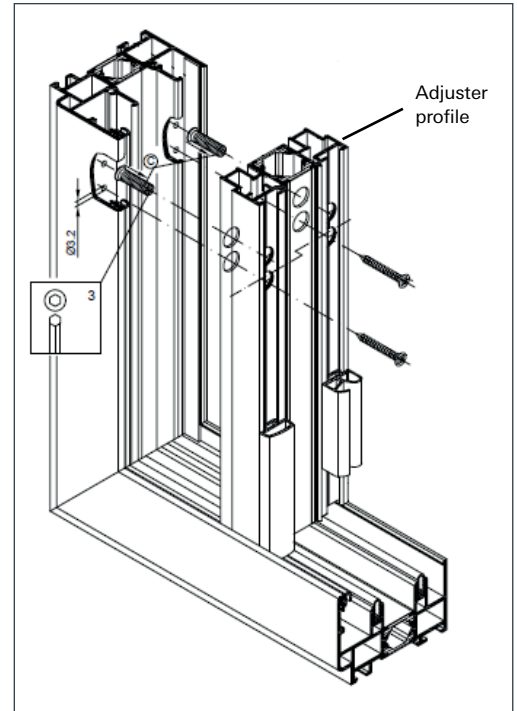

Installation of leaves

1. Attach the frame-hinged leaf **1** first by joining the hinge parts together and tapping in the hinge pins from the top.
2. Then attach the next leaf **2** joining the hinge parts and carry on with remaining leaves **3**. Do not forget that the roller body has to fit with the hinge parts on the roller body.

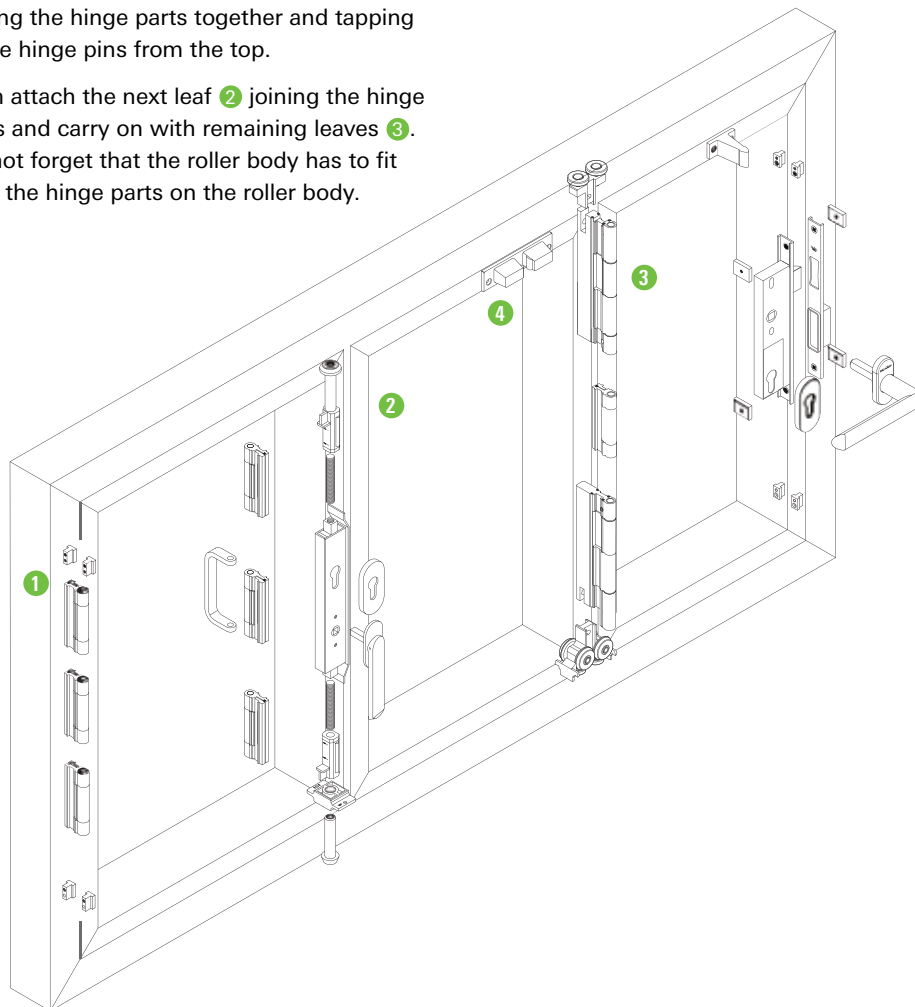

3. If there is an access door hinged to the folding leaves then a retaining catch **4** **must be fitted** to this door and the adjoining leaf. Before opening the folding leaves the access door should be hinged back on to the next leaf so that the catch engages. The remaining leaves can then be folded open.

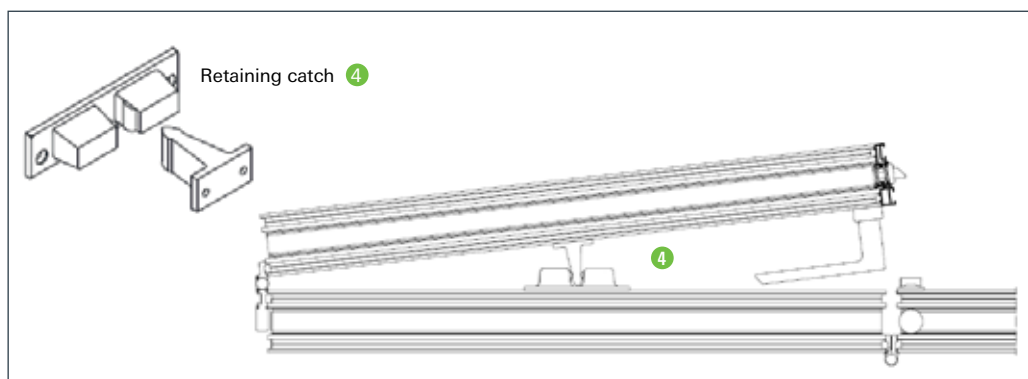

Glazing: door unit supplied unglazed

If the folding/sliding unit has been supplied unglazed OR if a glass unit is to be exchanged at a later date, follow the recommended glazing sequence:

Correct packing of the glass is essential to the proper functioning of the installed doors and to ensure that the leaves are square.

Glazing beads and gaskets are included with the delivery of the unit, together with glazing bridges on which the glass packers sit. Use plastic glazing packers only. Timber or rubber ones should not be used.

Glazing should be fitted into the installed, closed unit. The glass packers are positioned to provide support for the glass load and also as spacers and must be placed as shown in the diagrams (see page 10). The glass packers sit on the glazing bridges supplied which clip into the frame.

On all leaves the lower glass support packers must always be placed in the corner on the

hinge side, opposite to the locking mechanism.

Recommended glazing sequence (toe and heeling the glazing units)

1. Lock all the leaves in the frame in the closed position.
2. Start glazing with the first folding leaf hinged to the frame.
3. Measure the vertical beading and the height of the glass pane. The difference divided by two indicates the required thickness of packer (packers of different thickness may need to be combined).
4. Place the first packer at a distance of 100 mm in from the bottom corner on the hinge side of the leaf attached to the outer frame.
5. Set the glass into the frame and make sure it is standing properly on the packer. (With insulating glass make sure the packer is wide enough to support the full thickness of the glass unit)
6. Insert another packer on the vertical side also at a distance of 100 mm from the leaf bottom corner.
7. Now insert packers into the opposite corners 100 mm in from the leaf corner vertical then top horizontal.
8. Check that the leaf is plumb and square and add additional packers if necessary.
9. Now fit spacer packers as shown in the glazing diagrams. These are a push fit and help maintain the squareness of the leaf.
10. Use silicone to secure packers and spacers to prevent them slipping (the silicone must not touch the edge seal of the double glazing unit).
11. Clip beading into position and push in the glazing gasket.

Failure to pack the glass correctly may result in the unit touching the bottom or top frame and not folding correctly.

Positioning the glass support and spacer packers

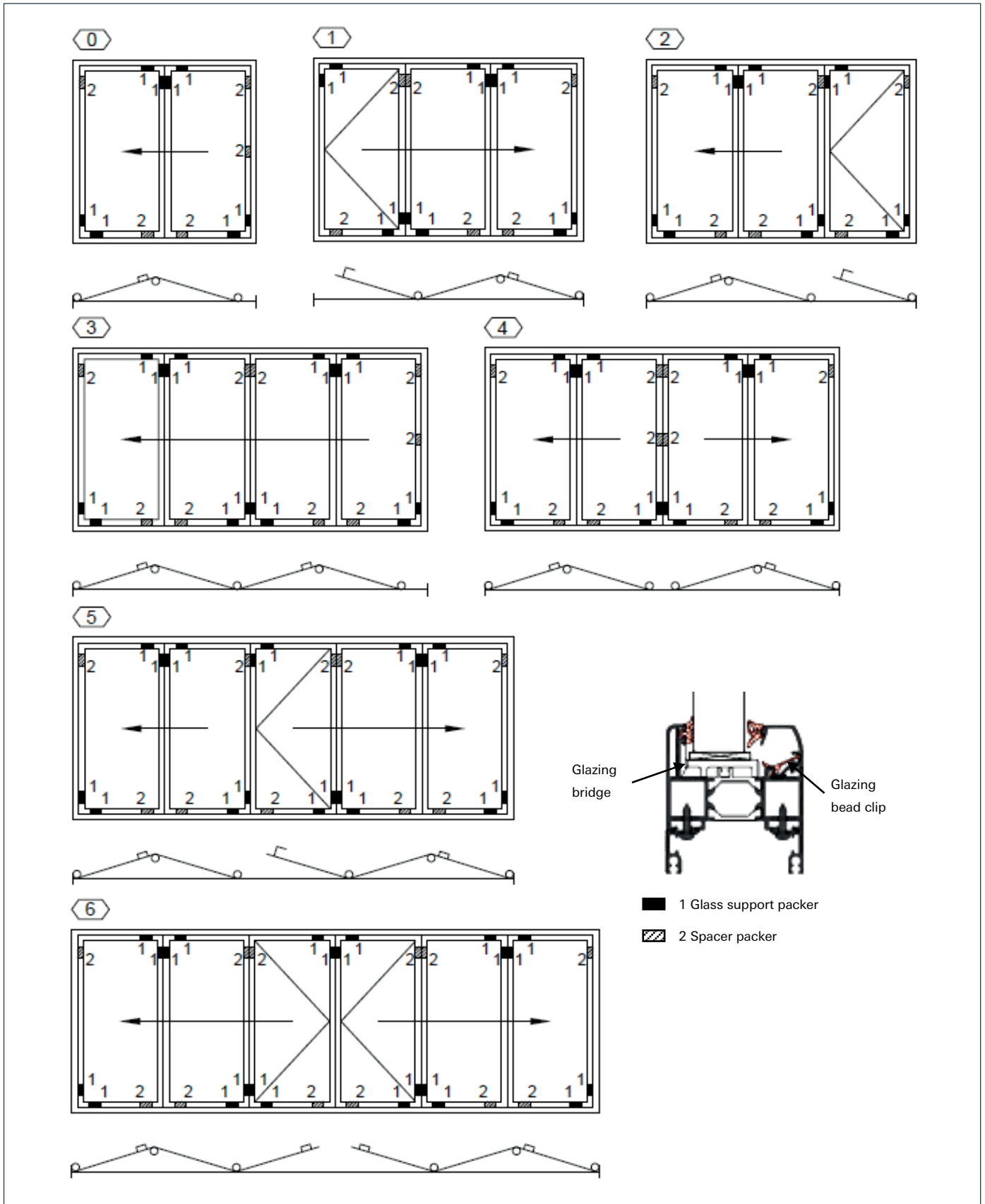

Glazing: door unit supplied factory glazed

If the folding/sliding unit has been supplied factory glazed then either de-glaze before installation and follow the glazing sequence (see previous pages) or install and check that the glazing is correctly "toe and heeled".

In either case the glazing beads should be removed with a thin spatula after first removing the internal glazing gasket (on re-fitting the beads make sure the plastic bead clips are in place).

Correct packing of the glass is essential to the proper functioning of the installed doors and to ensure that the leaves are square.

Important: outward opening access doors

Where door units are outward opening and have an access leaf ① (see example below), consideration should be given to restraint of this leaf if left open in windy conditions.

The customer should be consulted on this point.

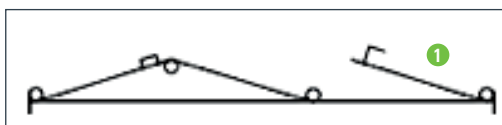

Final inspection

Before leaving site: test the unit and make sure tracks are clean and clear of any debris that could damage or affect the operation of the rollers.

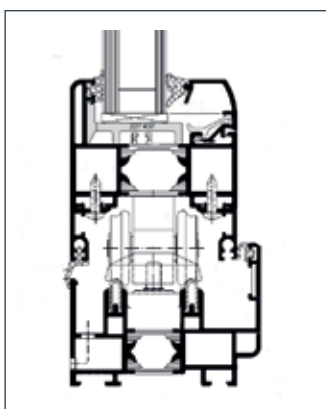

Remove any debris from the track area

- Explain operation and locking functions to the user
- Ensure all keys are left with user
- Leave Operation and Maintenance Guide with user



Schueco UK Ltd
www.schueco.co.uk

**Schueco – System solutions for windows, doors, façades
and solar products.**

Together with its worldwide network of partners, architects, specifiers and investors, Schueco creates sustainable building envelopes which focus on people and their needs in harmony with nature and technology. The highest demands for design, comfort and security can be met, whilst simultaneously reducing CO₂ emissions through energy efficiency, thereby conserving natural resources. The company and its Metal, PVC-U and New Energies divisions deliver tailored products for newbuilds and renovations, designed to meet individual user needs in all climate zones.